

# PNEUMATIC PLUGS

## FITTINGS

### FEMALE THREADED PNEUMATIQUE PLUG

#### ■ Technical description

The female pneumatic connector is a female coupler that will screw onto a 1/4" or 3/8" thread depending on the model.

Code	Designation	Characteristics
122644	Female air plug 1/4	G/F -thread 1/4
S22644	Security female air plug 1/4	G -thread 1/4*
142644	Female air plug 1/4	St -thread 1/4
122633	Female air plug 1/4	G -thread 3/8
S22633	Security female air plug 1/4	G -thread 3/8*
132833	Female air plug 3/8	G 3/8 -thread 3/8

\* decompression before uncoupling the safety coupling

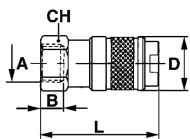

CODE	AIR PLUG SIZE	Ø Female thread	Type	A	B	CH	D	L
122644	1/4"	1/4"	G - F - UEC	1/4"	11	21	24	55
S22644	1/4"	1/4"	G - MP	1/4"	12	19	26	75
142644	1/4"	1/4"	St - CRP	1/4"	12	19	22	55
122633	1/4"	3/8"	G - F - UEC	3/8"	11,5	21	24	55,5
S22633	1/4"	3/8"	G - MP	3/8"	10	22	26	91
132833	3/8"	3/8"	G - F - UEC	3/8"	11,5	24	28	56,5

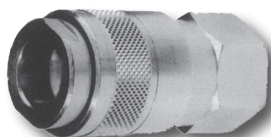

More information on our website :



# PNEUMATIC PLUGS

## FITTINGS

### MALE THREADED PNEUMATIQUE PLUG

#### ■ Technical description

The male pneumatic fitting is a female coupler that will screw into a 1/4" or 3/8" thread depending on the model.

Code	Designation	Characteristics
121644	Female air plug 1/4	G/F - thread 1/4
S21644	Security female air plug 1/4	G - thread 1/4*
141644	Female air plug 1/4	St - thread 1/4
121633	Female air plug 1/4	G/F - thread 3/8
S21633	Security female air plug 1/4	G - thread 3/8*
131833	Female air plug 3/8	G 3/8 - thread 3/8

\* decompression before uncoupling the safety coupling

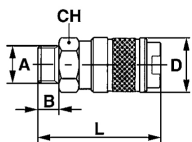

CODE	AIR PLUG SIZE	Ø male thread	Type	A	B	CH	D	L
121644	1/4"	1/4"	G - F - UEC	1/4"	8	21	24	53
S21644	1/4"	1/4"	G - MP	1/4"	12	19	26	75
141644	1/4"	1/4"	St - CRP	1/4"	8	19	22	52
121633	1/4"	3/8"	G - F - UEC	3/8"	9	21	24	54
S21633	1/4"	3/8"	G - MP	3/8"	9	19	26	75
131833	1/4"	3/8"	G - F - UEC	3/8"	9	24	28	56

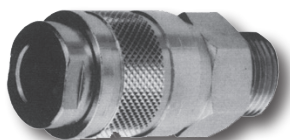

More information on our website :





# PNEUMATIC PLUGS

## FITTINGS

### PNEUMATIC PLUG FOR HOSE

#### ■ Technical description

The pneumatic hose coupling is a female coupler that will fit onto a hose with a clamp.

Code	Designation	Characteristics
125608	Female air plug for hose Ø8	G/F - 1/4
S25608	Secured female air plug for hose Ø8	G - 1/4*
145608	Female air plug for hose Ø8	St - 1/4
125610	Female air plug for hose Ø10	G - 1/4
S25610	Secured female air plug for hose Ø10	G - 1/4*
135808	Female air plug for hose Ø8	G - 3/8

\* decompression before uncoupling the safety coupling

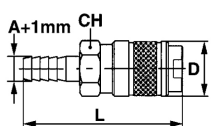

CODE	AIR PLUG SIZE	Ø hose	Type	A	B	CH	D	L
125608	1/4"	8	G - F - UEC	8	-	21	24	64
S25608	1/4"	8	G - MP	8	-	14	26	100
145608	1/4"	8	St - CRP	8	-	19	22	64
125610	1/4"	10	G - F - UEC	10	-	21	24	64
S25610	1/4"	10	G - MP	10	-	15	26	110
135808	3/8"	8	G - MP	8	-	24	28	66



More information on our website :



# PNEUMATIC PLUGS

## FITTINGS

### TURNING PNEUMATIC PLUG HOLDER

#### ■ Technical description

In addition to a female coupling or spigot. The swivel fitting is ideal for a hose and prevents it from turning on itself.

Code	Designation	Characteristics
TU1014PT	turning plug	with spring
1010CM38	turning plug	with spring

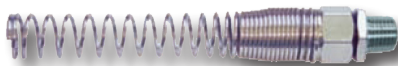

More information on  
our website :





# PNEUMATIC PLUGS

TIP

## FEMALE PNEUMATIC PLUG

### ■ Technical description

Code	Designation	Characteristics
T023904	Male air plug 1/4	G -thread 1/4
242644	Male air plug 1/4	St -thread 1/4
T023404	Male air plug 1/4	F -thread 1/4
T023905	Male air plug 1/4	G -thread 3/8
232833	Male air plug 3/8	G -thread 3/8
242633	Male air plug 1/4	St -thread 3/8
T023405	Male air plug 1/4	F -thread 3/8

CODE	AIR PLUG SIZE	Ø Female thread	Type	A	B	CH	D	L
T023904	1/4"	1/4"	G - MP	1/4"	12	17	-	38
242644	1/4"	1/4"	St	1/4"	11	17	-	41
T023404	1/4"	1/4"	F - OP	1/4"	12	17	-	35
T023905	1/4"	3/8"	G - MP	3/8"	12	19	-	41
232833	3/8"	3/8"	G - MP	3/8"	14	19	-	40
242633	1/4"	3/8"	St	3/8"	12	19	-	41
T023405	1/4"	3/8"	F - OP	3/8"	12	19	-	39

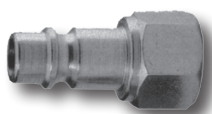
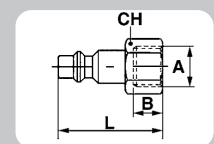

More information on our website :



# PNEUMATIC PLUGS

TIP

## MALE PNEUMATIC PLUG

### ■ Technical description

Code	Designation	Characteristics
T023901	Male air plug 1/4	G - thread 1/4
241644	Male air plug 1/4	St - thread 1/4
T023401	Male air plug 1/4	F - thread 1/4
T023902	Male air plug 1/4	G - thread 3/8
231833	Male air plug 3/8	G - thread 3/8
241633	Male air plug 1/4	St - thread 3/8
T023402	Male air plug 1/4	F - thread 3/8
3815154	Male air plug 3/8	St - thread 3/8

CODE	AIR PLUG SIZE	Ø Of the thread	Type	A	B	CH	D	L
T023901	1/4"	1/4"	G - MP	1/4"	9	14	-	38
241644	1/4"	1/4"	St	1/4"	9	17	-	41
T023401	1/4"	1/4"	F - OP	1/4"	9	14	-	35
T023902	1/4"	3/8"	G - MP	3/8"	11	17	-	41
231833	3/8"	3/8"	G - MP	3/8"	9	19	-	40
241633	1/4"	3/8"	St	3/8"	13	17	-	56
T023402	1/4"	3/8"	F - OP	3/8"	11	17	-	48
3815154	3/8"	3/8"	St	3/8"	9	19	-	42

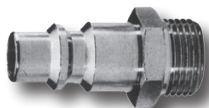
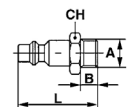

More information on our website :





# PNEUMATIC PLUGS

TIP

## PNEUMATIC PLUG FOR HOSE

### ■ Technical description

Code	Designation	Characteristics
T024002	Plug for hose Ø8	G - 1/4
235808	Plug for hose Ø8	G - 3/8
245608	Plug for hose Ø8	St - 1/4
T0234019	Plug for hose Ø8	F - 1/4
235810	Plug for hose Ø10	G - 3/8

CODE	AIR PLUG SIZE	Ø Of the thread	Type	A	B	CH	D	L
T024002	1/4"	8	G - MP	8	-	-	12	48
235808	3/8"	8	St	8	-	-	12	40
245608	1/4"	8	F - OP	8	-	-	12	51
T0234019	1/4"	8	G - MP	8	-	-	12	38
235810	3/8"	10	G - MP	10	-	-	12	40

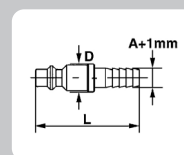

More information on our website :



# PNEUMATIC PLUGS

OTHER

Teflon and 360°  
turning plug

## ■ Technical description

Code	Designation
TEFLON	Teflon 12 x 12
RACOR360	360° turning plug - 2 x 1/4" plugs
RACOR361	360° turning plug - 1 threads 1/4 et 1 plugs G 1/4
RACOR362	360° turning plug - 2 threads 1/4



More information on  
our website :







# PNEUMATIC PLUGS

## HOSE SOCKET

### ■ Technical description



Code	Designation	Characteristics
304048	hose socket Ø 8	1/4
304032	hose socket Ø13	3/8

## NIPPLE

### ■ Technical description



Code	Designation	Characteristics
201088	Double nipple male	1/8 male x 1/8 male
201044	Double nipple male	1/4 male x 1/4 male
201033	Double nipple male	3/8 male x 3/8 male
201022	Double nipple male	1/2 male x 1/2 male

More information on our website:





# PNEUMATIC PLUGS

## REDUCTION

### ■ Technical description

Code	Designation	Characteristics
203084	Reduction male/male	1/8 male x 1/4 male
203043	Reduction male/male	1/4 male x 3/8 male
203042	Reduction male/male	1/4 male x 1/2 male
209048	Reduction male/female	1/4 male x 1/8 female
209034	Reduction male/female	3/8 male x 1/4 female
209024	Reduction male/female	1/2 male x 1/4 female
209012	Reduction male/female	3/4 male x 1/2 female
205048	Reduction female/male	1/4 female x 1/8 male



Reduction male/male



Reduction male/female

More information on our website :







# PNEUMATIC PLUGS

## RACCORD

### ■ Technical description

Code	Designation	Characteristics
601044	Raccord Y	1/4 female
601033	Raccord Y	3/8 female
400044	Raccord T	1/4 female
405044	Raccord T	1/4 female/female/male
602044	female cross	1/4 F



## COLLAR

### ■ Technical description

Code	Designation	Characteristics
PBS90814	Collar	Ø 8 à 14
PBS91320	Collar	Ø 13 à 20



More information on our website :

